

The Milton Hershey School New Supply Center Hershey, PA

PROJECT DELIVERY TEAM

Building Owner/Operator: The Milton Hershey School
Architect: Spillman Farmer Architects
Structural Engineer: Barry Isett and Associates, Inc.
MEP Engineer: H. F. Lenz Company
Civil/Site Development: Pennoni Associates, Inc.
Food Service: Orlando Espinosa and Associates

PROJECT INFORMATION

Overall Cost Estimate: \$23,500,000
Project Size: 110,000 square feet
Project Delivery Method: Design-Bid-Build
Construction Dates: Start - July 2006
Finish - July 2007
Number of Stories: One above grade
Elevated Mechanical Mezzanine Rooms

ARCHITECTURE

Function: Central Food Distribution Center
Central Mail Distribution Center
Clothing Store With Alterations Area
Dry and Temperature Controlled Storage
Envelope: Metal Vertical Wall Panels
27 Clearstory Light Shafts

STRUCTURAL SYSTEM

Skeleton: Steel Beams, Columns, and Girders
Interior Load Bearing CMU Walls
K-Series Joist Supporting Roof
5" Concrete Slab on Grade Flooring - 4000 psi
Continuous and Spread Foundation

MECHANICAL SYSTEMS

- 14 Air Handling Units Ranging From 3,000 - 22,000 CFM
- VAV System With Terminal Boxes and VFD
- Two 270 Ton Centrifugal Water Cooled Chillers
- Water Side "Free" Cooling
- Two 35 Ton (20 Degree Water) Brine Chillers
- For FCU's In Walk-In Coolers
- Two 200 BHP Gas Fired Fire Tube Boilers
- One 125 BHP Gas Fired Fire Tube Boiler
- 40 psi Medium Pressure Steam For Process Loads
- Converts To Hot Water For Building Loads

LIGHTING/ELECTRICAL SYSTEMS

- 480/277V, 3Phase, 4 Wire Service
- 480 To 208/120V Transformers
- Emergency 750kW Diesel Fueled Generator
- Lighting: Generally 277V Fluorescent Fixtures
- T-8 Lamps
- 2x4 and 4x4 Recessed Troffers
- 1x4 Surface Mounted Fixtures With Cold Weather Ballast For Walk-in Freezers
- Ground/Wall Mounted 39-70W Metal Halide Outdoor Fixtures

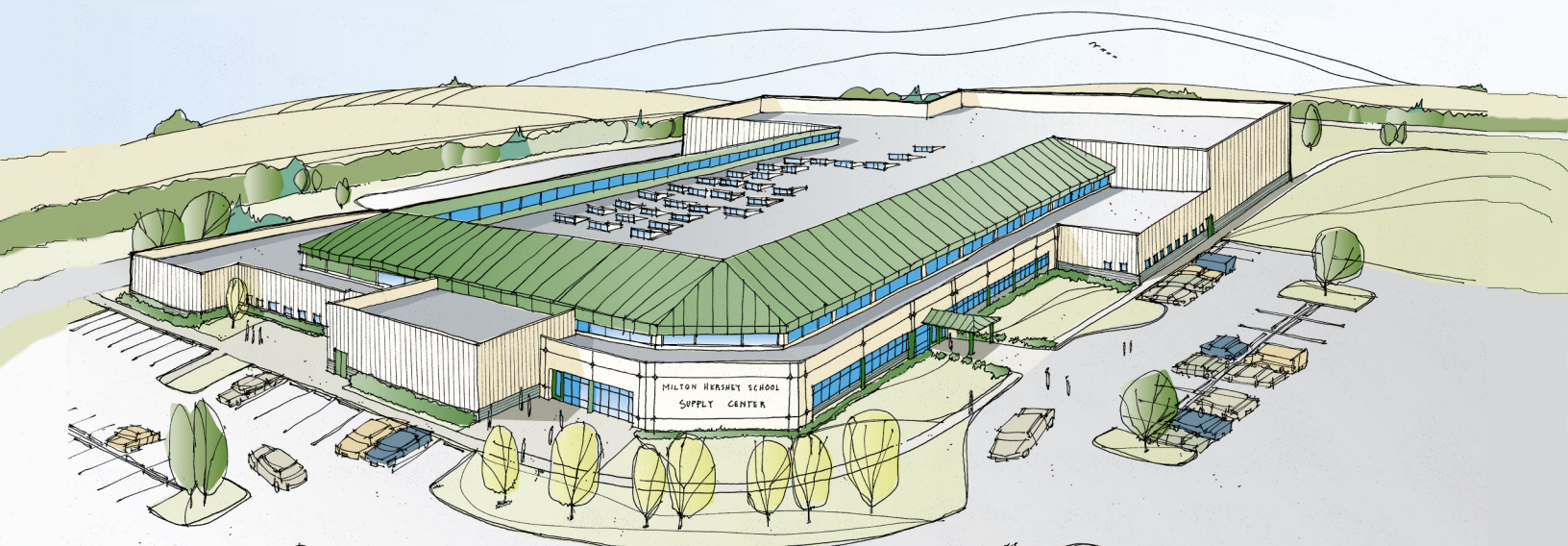

JUSTIN BEM

MECHANICAL OPTION